



# STEAM JACKETED KETTLES

## ELECTRIC TABLE TOP TILTING KETTLE MODELS TDB MARINE

Kettle shall be a Groen Model TDB-20, TDB-40 with mechanical controls or TDB-20C with Classic electronic control, stainless steel manual tilting self-contained steam jacketed unit, with an electric heated steam source contained within the unit.

### AVAILABLE MODELS:

#### MECHANICAL CONTROLS:

TDB-20 (20 QUART)

TDB-40 (40 QUART)

#### CLASSIC CONTROLS:

TDB-20C (20 QUART)

**CONSTRUCTION:** Kettle interior shall be of type 316 stainless steel with solid one-piece welded construction. All exposed surfaces shall be stainless steel. Unit shall have a heavy reinforced rim with a welded-in butterfly shaped pouring lip for maximum sanitation and durability. Right and left hand tilt handle mounts provided. Faucet bracket is standard and mounted on rear of controls/trunnion enclosure.

**FINISH:** Interior of kettle shall be polished to a 180 emery grit finish. Exterior of kettle shall be finished to a bright high buff finish, ensuring maximum ease in cleaning, protection against salt water environments and maintaining a brilliant appearance.

**ASME CODE, UL LISTING:** Unit shall be ASME shop inspected, stamped and registered with the National Board for operation up to a maximum working pressure of 50 PSI. Unit shall be UL listed.

**SANITATION:** Unit shall be designed and constructed to meet NSF and known health department and sanitation codes, and NSF listed.

**SELF-CONTAINED STEAM SOURCE:** Kettle shall have an electrically heated self-contained steam source to provide kettle temperatures of 150°F to approximately 287°F. Unit shall be factory charged with water and rust inhibitors, to ensure long life and minimum maintenance.

**CONTROLS:** Controls to be located in right-side water resistant (IPX6 rated) trunnion enclosure:

**Mechanical Control Models** include: Power ON-OFF switch, temperature control knob, 100 to 287°F range increments and HEAT(ing) indicator light; **Classic -C Models** include: Power ON-OFF switch with indicator light, temperature control knob with 1 to 10 increments, HEAT(ing) indicator light and LOW WATER warning light (IPX6 water resistance rating).

**SAFETY SYSTEMS:** Kettle shall have safety tilt cut-off (cuts off heat when tilted more than 12°), pressure relief valve, high limit pressure switch, low water cut-off and 24-volt control system.

**PERFORMANCE/FEATURES:** Unit shall be thermostatically controlled to automatically shut off when desired temperature is reached and to turn on when product temperature falls below desired setting. Design shall make it easy for one person to precisely tilt kettle, when filled to capacity. Pouring height allows filling of 4" deep pans on the table top. Tilt handle is field reversible for right or left-hand tilt.

**INSTALLATION:** One electrical connection required. All marine units are available in 240 Volt, single and three phase, 440 or 480 Volt, three-phase, 60Hz electrical service.



PROJECT NAME:	
LOCATION:	
ITEM NO:	
QTY:	
MODEL NO:	
AIA NO:	
SIS NO:	
CSI SECTION:	11400



TDB-20C Model shown

### OPTIONS/ACCESSORIES:

Etch marks, gallons  
Etch marks, liters  
Single pantry faucet  
Double pantry faucet  
Single pantry pre-rinse  
Double pantry pre-rinse  
Wire basket insert  
Nylon basket liner  
Liner retaining ring  
Lift off cover  
Cover holder  
Cover strainer  
Kettle support stand  
Drain cart  
Drain cart plumbing kit

### ADDITIONAL RESOURCES:

[Request A Quote](#)

[Sales Tools](#)

[Find A Rep](#)

TABLE OF DIMENSIONS									
MODEL DIM	TDB-20		TDB-24		TDB-40		TDB-48		
	INCH	MM	INCH	MM	INCH	MM	INCH	MM	
A	14	356	14	356	16.5	419	16.5	419	
B	17.6	447	17.6	447	19.2	488	19.2	488	
C	24	610	24	610	28.0	711	28.0	711	
D	20.8	528	20.8	528	22.4	569	22.4	569	
F	23.1	587	24.6	625	25.1	632	27.3	693	
H	25.6	650	25.6	650	28.0	711	28.0	711	
J	15.5	394	16.0	406	18.5	470	19.0	483	
K	3.5	89	5.0	127	7.5	191	9.8	249	
L	5.5	140	5.5	140	4.3	109	4.3	109	

ELECTRICAL REQUIREMENTS TABLE					
KETTLE MODEL	TDB-20 & 24		TDB-40 & 48		
	VOLTS	PHASE	KW	AMPS	
208	13	3	6.3	18	52
	240	1	8.4	35	60
240	3	3	6.3	20	35
	440	38	6.3		15
480	38	6.3			15

SERVICE CONNECTIONS AND NOTES:

- 1 ELECTRICAL SUPPLY: 3/4" WATER RESISTANT CONDUIT (1" FOR 240V, 1 PHASE)
- 2 DIMENSIONS IN BRACKETS [ ] ARE MM.
- 3 MAXIMUM WIDTH - TDB 20/24 IS 25 3/4" AND TDB-40/48 IS 28"

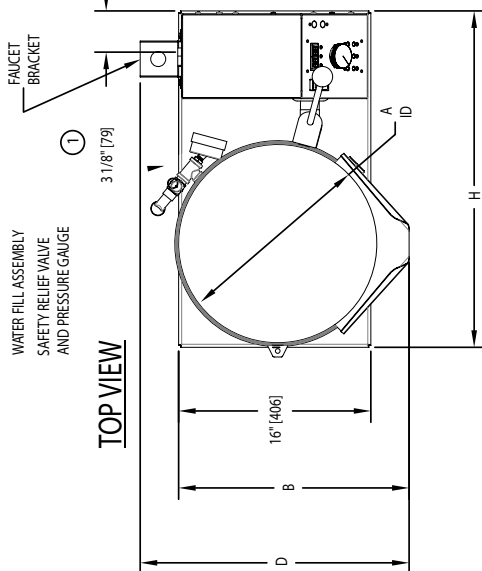

MAXIMUM WIDTH  
SEE NOTE #3

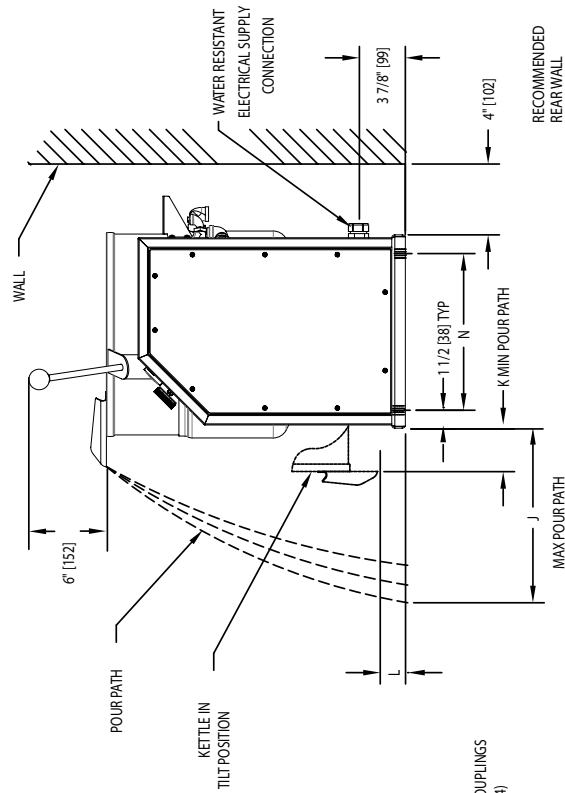
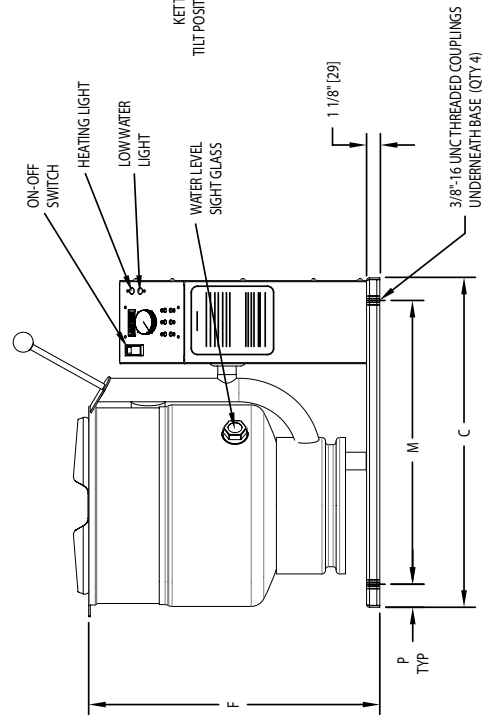

P/N 175842 REV A

