



PREP STATIONS

SPECIALTY CUSTOM REMOTE WORKTOP REFRIGERATOR MODELS 53000

Remote refrigerator base with 16 gauge reinforced stainless steel top, and integral backsplash with 45° return. Stainless steel doors on concealed hinges. Condensing unit not provided. Evaporator blower coil with expansion valve supplied and installed. 6" high adjustable and movable legs.

SHORT FORM SPEC: Randell 53000 series model worktop refrigerator base with remote refrigeration system. Top to be 1 piece die formed stainless steel with corrosion resistant exterior body. Includes Randell evaporator blower coil fitted to base, complete with expansion valve and refrigeration lines installed for connection at rear of unit. Base interior ends and door openings shall be high impact ABS plastic with coved corner stainless steel interior to form bottom, back and top of cabinet. Base cabinet door to have ABS liner and include press-fit magnetic gaskets for positive sealing to ABS formed door opening frame. Unit to be shipped on standard 6" adjustable legs mounted to full length channel frame assembly allowing movement of legs to avoid floor obstacles. cUL, UL, NSF.

AVAILABLE MODELS:

53330
53333
53336
53339
53348
53351
53354
53357
53360
53369
53372
53375
53378
53381
53384
53387
53102
53114

STANDARD FEATURES:

- Available under one piece top with other modular equipment up to 16' in length
- 6" high legs—adjustable and movable
- Foamed in place "CFC free" urethane insulation
- Refrigeration system utilizes expansion valve and mechanical control for field adjustability
- 45° integral stainless backsplash is standard, 90° stainless backsplash is optional
- Filter dryer installed on liquid line

CABINET EXTERIOR: Top to be one piece of die formed 16 gauge stainless steel with 2 1/2" nosing. Backsplash to be coved cornered, with 45° return at top and overall height of 6 3/4". Ends at top fitted with recessed heavy duty steel bars for field bolting units together, producing a hairline seam. Exterior body to be

corrosion resistant steel. Door opening frame to be ABS and contain magnetic strip for positive sealing of gaskets. Work surface to be at 36" work height. Legs to be 6" high stainless steel with adjustable bullet foot. Legs mounted to full length channel frame assembly which is integrally welded to bottom of body assembly. Legs can be moved left to right to avoid floor obstacles during installation.

CABINET INTERIOR: Base interior to be ABS thermoplastic at ends only. Stainless steel interior liner to be coved cornered to form bottom, back and top. One baked enamel finished shelf provided behind each door. Unit insulation to be CFC free foamed in place urethane.

DOORS: Door fronts to be 22 gauge stainless steel with 16 gauge stainless steel handles, magnetic gaskets, ABS door liner and foamed in place insulation. Hinges are concealed, all stainless steel with bronze pivot pin in nylon bushing.

REFRIGERATION: Refrigerant to be specified by customer (specification based on R-448a refrigerant). Interior fitted with Randell evaporator blower coil for cooling base. The unit is thermostatically controlled operating on solenoid and expansion valve (located in the mechanical housing at the rear of the unit). Condensing unit not provided. Unit prewired to junction box for 115V operation. Electric condensate evaporator is optional.



PROJECT NAME:	
LOCATION:	
ITEM NO:	
QTY:	
MODEL NO:	
AIA NO:	
SIS NO:	
CSI SECTION:	11400



Model 53360 shown with optional finished ends and extended mechanical housing

OPTIONS/ACCESSORIES:

Dimensional Modification (Length, Height, Depth)
Backsplash Removed, Modified
Stainless Riser/Divider, End Splash
14 Gauge Top
Marine Edge Top
Adjustable Shelves
Additional Shelves
Two-Tier Drawers (6" Deep Pans)
Triple-Tier Drawers (4" Deep Pans)
Door/Drawer Locks
Electric Condensate Evaporator
Tray Rack
Stainless Steel End(s), Back Panel
Laminated End(s), Back Panel, Doors
Stainless Steel Interior
Mechanical Housing Location Right
Electrical Connections (Backsplash)
Sinks; Handwash, Utility, Dipperwell
Built-In Hot Well, Soup Well
Curb Mount
Channel Base
Cutting Board

ADDITIONAL RESOURCES:

[Request A Quote](#)

[Sales Tools](#)

[Find A Rep](#)

53330

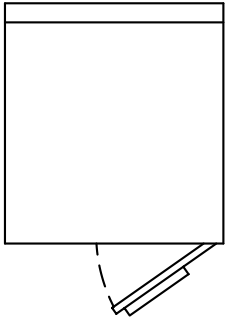

53333

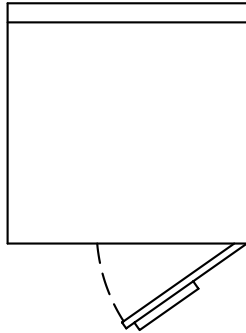

53336

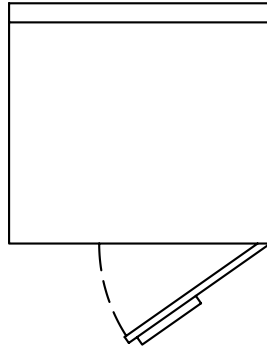

53339

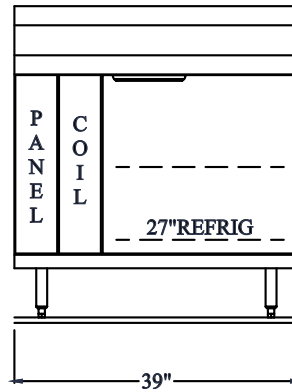
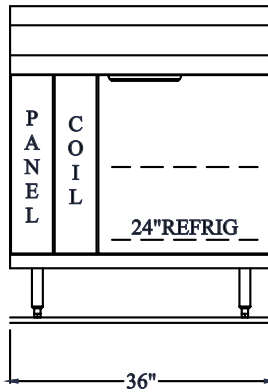
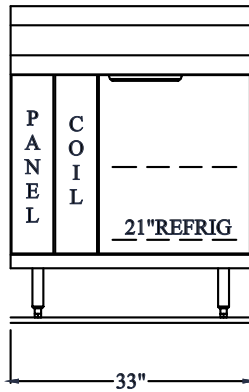
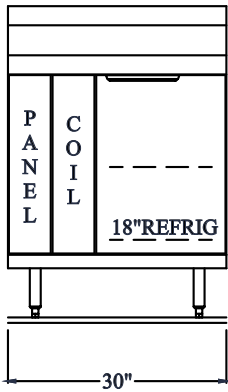
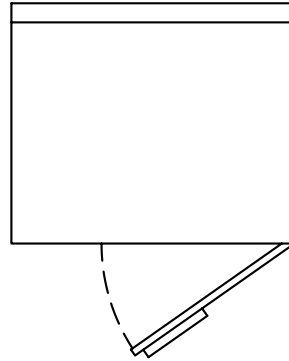

MODEL	BASE SECTION(S)	LENGTH	DEPTH	WORK HEIGHT	OVERALL HEIGHT	STANDARD REF. BASE CONFIGURATION	BASE STORAGE CUBIC FT CAPACITY	VOLT/ CYCLE/ PHASE	AMPS	BTU LOAD*	BTU EVAP.**	SHIP WT.
1 SECTION BASE STORAGE												
53330	1	30"	33"	36"	42.75"	(1) 18" DOOR, 6" COIL	4.12	115/60/0	5	450	120	295
53333	1	33"	33"	36"	42.75"	(1) 21" DOOR, 6" COIL	5.05	115/60/1	5	486	120	305
53336	1	36"	33"	36"	42.75"	(1) 24" DOOR, 6" COIL	5.98	115/60/1	5	523	120	320
53339	1	39"	33"	36"	42.75"	(1) 27" DOOR, 6" COIL	6.91	115/60/1	5	561	120	335

*BTU loads shown are based on 100° ambient plus 30% for usage and product loading in base. Final system selection should consider usage requirements and combined loads. *

**Evaporator BTU/TD reflects NSF refrigerated base requirements when base is provided with +20° F system.

***Additional length added to mechanical housing

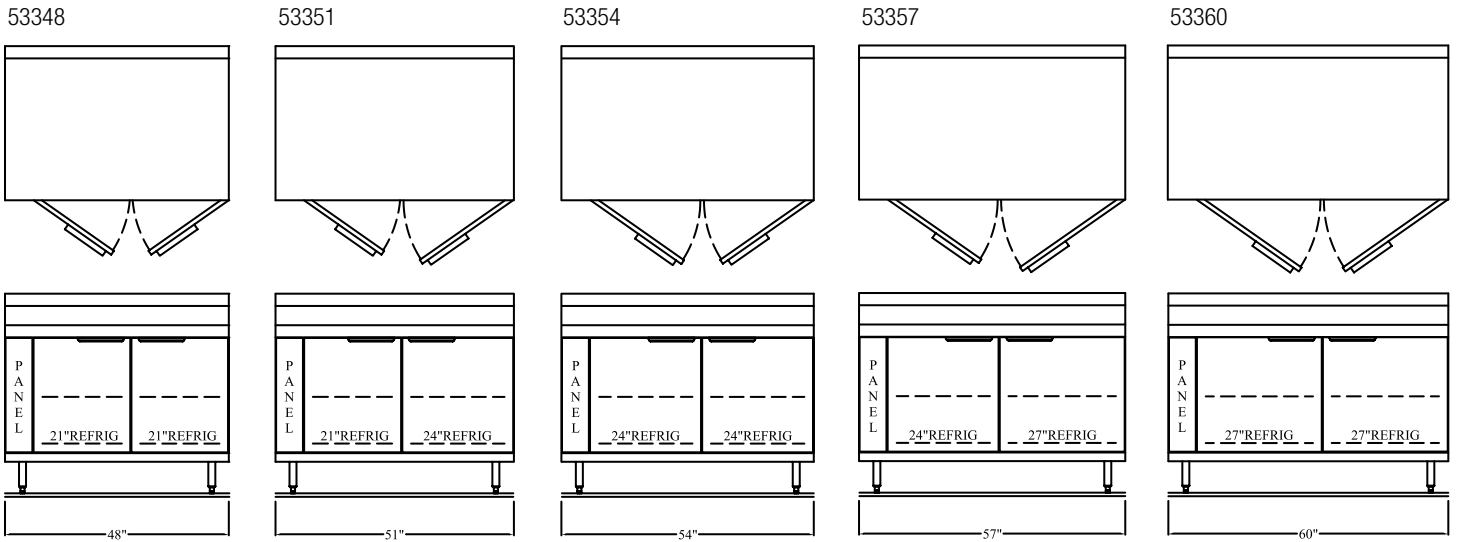

MODEL	BASE SECTION(S)	LENGTH	DEPTH	WORK HEIGHT	OVERALL HEIGHT	STANDARD REF. BASE CONFIGURATION	BASE STORAGE CUBIC FT CAPACITY	VOLT/ CYCLE/ PHASE	AMPS	BTU LOAD*	BTU EVAP.**	SHIP WT.
2 SECTION BASE STORAGE												
53348	2	48"	33"	36"	42.75"	(2)21" DOORS	10.09	115/60/1	5	598	120	350
53351	2	51"	33"	36"	42.75"	(1)21" DOOR (1)24" DOOR	11.02	115/60/1	5	895	120	380
53354	2	54"	33"	36"	42.75"	(2)24" DOORS	11.96	115/60/1	5	933	120	395
53357	2	57"	33"	36"	42.75"	(1)24" DOOR (1)27" DOOR	12.89	115/60/1	5	970	120	410
53360	2	60"	33"	36"	42.75"	(2)27" DOORS	13.82	115/60/1	5	1008	120	435

*BTU loads shown are based on 100° ambient plus 30% for usage and product loading in base. Final system selection should consider usage requirements and combined loads. *

**Evaporator BTU/TD reflects NSF refrigerated base requirements when base is provided with +20° F system.

***Additional length added to mechanical housing

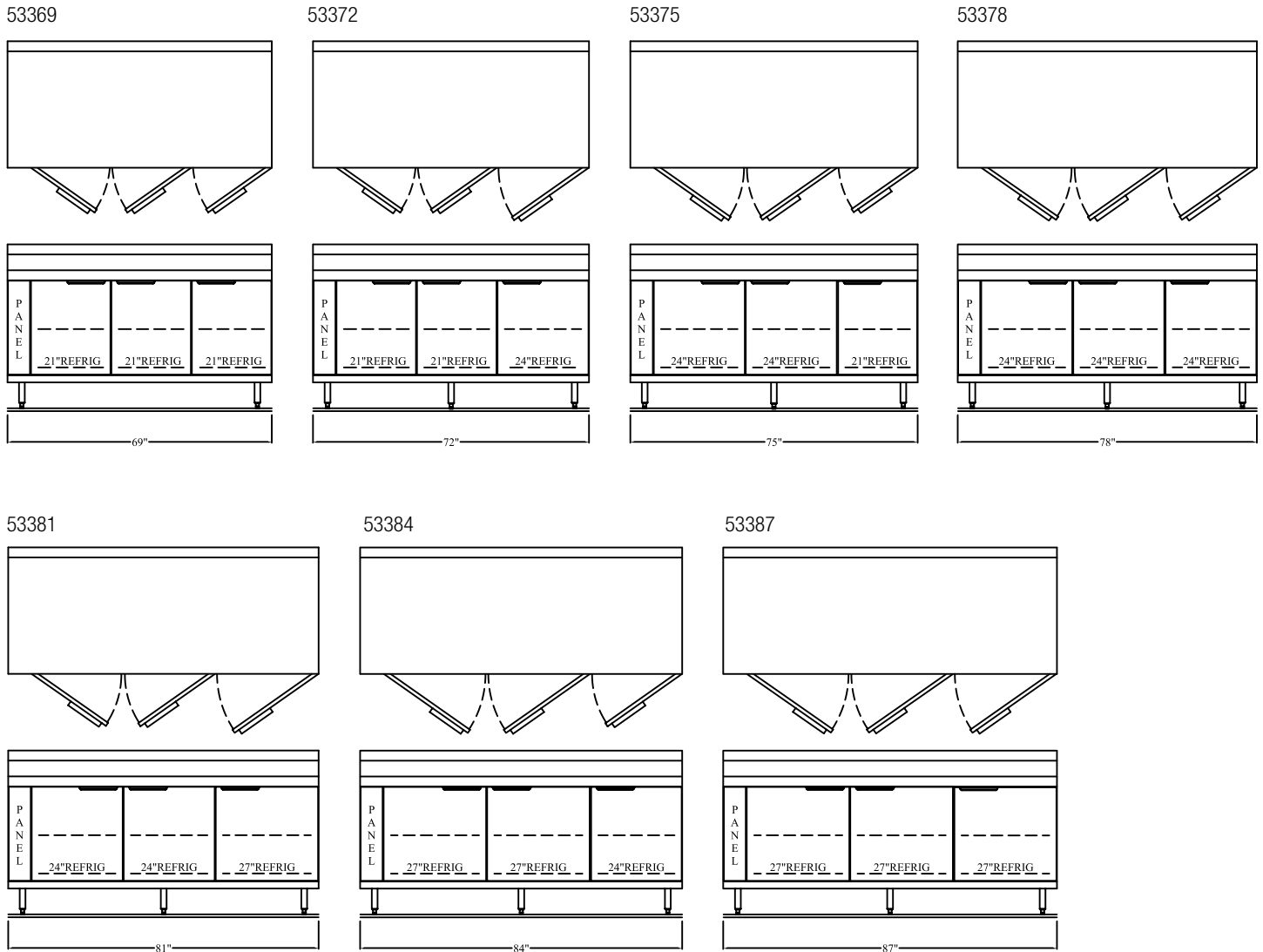

MODEL	BASE SECTION(S)	LENGTH	DEPTH	WORK HEIGHT	OVERALL HEIGHT	STANDARD REF. BASE CONFIGURATION	BASE STORAGE CUBIC FT CAPACITY	VOLT/ CYCLE/ PHASE	AMPS	BTU LOAD*	BTU EVAP.**	SHIP WT.
3 SECTION BASE STORAGE												
53369	3	69"	33"	36"	42.75"	(3)21" DOORS	15.14	115/60/1	5	1045	120	450
53372	3	72"	33"	36"	42.75"	(2)21" DOORS (1)24" DOOR	16.07	115/60/1	5	1342	120	495
53375	3	75"	33"	36"	42.75"	(2)24" DOORS (1)21" DOOR	17	115/60/1	5	1380	120	510
53378	3	78"	33"	36"	42.75"	(3)24" DOORS	17.93	115/60/1	5	1417	120	535
53381	3	81"	33"	36"	42.75"	(2)24" DOORS (1)27" DOOR	18.87	115/60/1	5	1455	240	550
53384	3	84"	33"	36"	42.75"	(2)27" DOORS (1)24" DOOR	19.8	115/60/1	5	1492	240	565
53387	3	87"	33"	36"	42.75"	(3)27" DOORS	20.73	115/60/1	5	1567	240	595

*BTU loads shown are based on 100° ambient plus 30% for usage and product loading in base. Final system selection should consider usage requirements and combined loads. *

**Evaporator BTU/TD reflects NSF refrigerated base requirements when base is provided with +20° F system.

***Additional length added to mechanical housing

53102

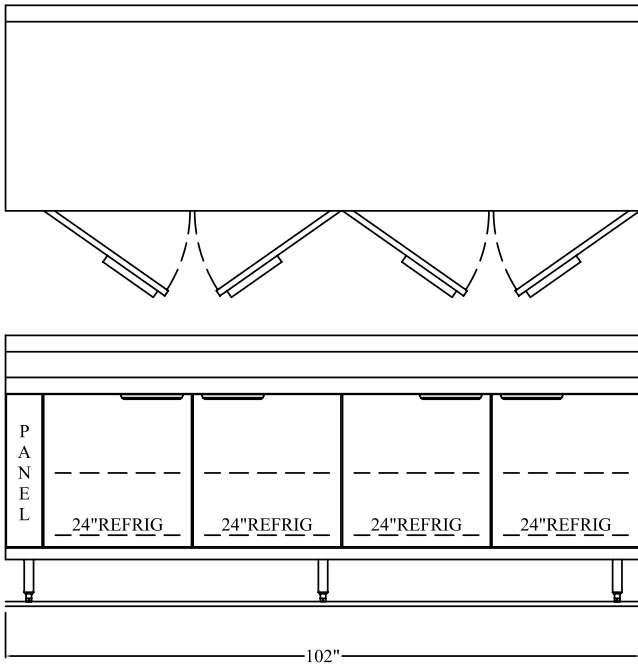

53114

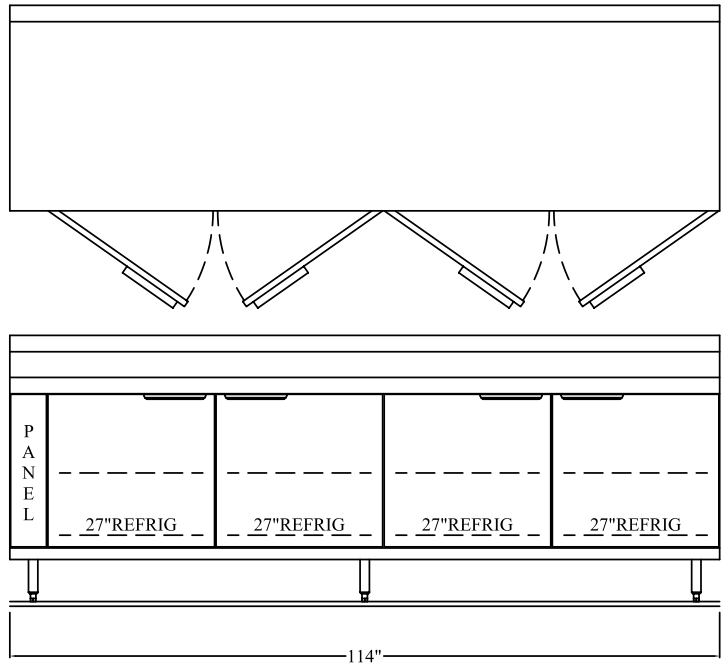

MODEL	BASE SECTION(S)	LENGTH	DEPTH	WORK HEIGHT	OVERALL HEIGHT	STANDARD REF. BASE CONFIGURATION	BASE STORAGE CUBIC FT CAPACITY	VOLT/ CYCLE/ PHASE	AMPS	BTU LOAD*	BTU EVAP.**	SHIP WT.
4 SECTION BASE STORAGE												
53102	4	102"	33"	36"	42.75"	(4)24" DOORS	23.91	115/60/1	5	1939	240	655
53114	4	114"	33"	36"	42.75"	(4)27" DOORS	27.64	115/60/1	5	2090	240	700

*BTU loads shown are based on 100° ambient plus 30% for usage and product loading in base. Final system selection should consider usage requirements and combined loads. *

**Evaporator BTU/TD reflects NSF refrigerated base requirements when base is provided with +20° F system.

***Additional length added to mechanical housing

DOORS:

DOOR OPENING SIZES	CLEARANCES THROUGH DOOR		INTERIOR DEPTH BEHIND DOOR	ACCEPTS SHEET PAN SLIDES	OPTIONAL DRAWER PAN CAPACITY (PER DRAWER)
	LT. TO RT.	TOP TO BOTTOM	FRONT TO BACK*		
18"	13 1/4"	20 1/4"	26.5"	No	N/A
21"	16 1/4"	20 1/4"	26.5"	No	(1) 12"x20"x6"
24"	19 1/4"	20 1/4"	26.5"	Yes	(1) 12"x20"x6" + (3) 1/9"
27"	22 1/4"	20 1/4"	26.5"	Yes	(2) 12"x20"x6"

*Shelf depth is 25-1/4" on 33" deep equipment.

OPTIONAL DRAWERS:

21" Drawer:

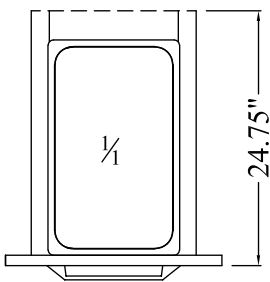

24" Drawer:

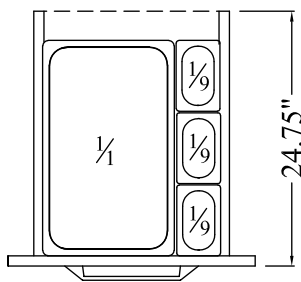

27" Drawer:

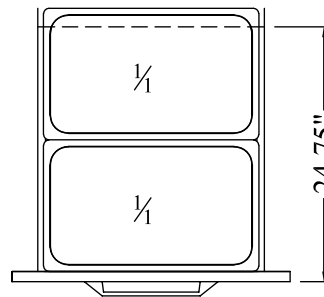

32" Drawer:

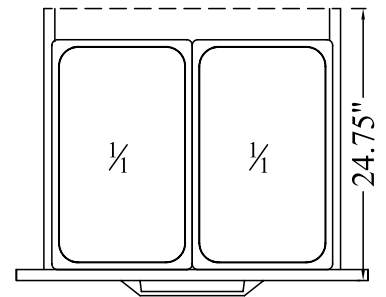

DIMENSIONAL DETAIL:

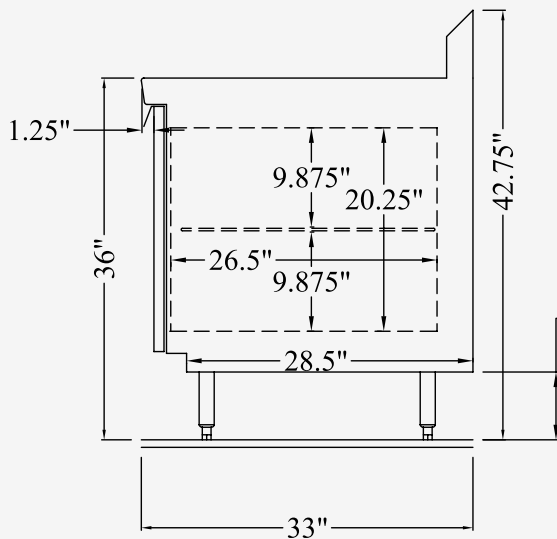

LEGS ADJUSTABLE
FROM: 6" - 7.125"
SHOWN @ 6.75"

Stainless Steel Finished End:

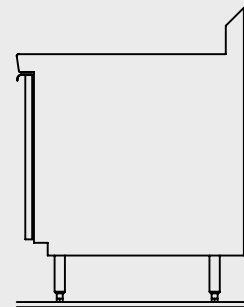

Unfinished End:

